

THE HIGHLAND MEADOWS PUD WATER SYSTEM WILL BE OWNED AND OPERATED BY EITHER A LOCAL COLORADO CORPORATION OR A LOCAL MUNICIPAL DISTRICT AS PROVIDED BY COLORADO STATE STATUTES. ALL CRITERIA FOR WATER QUALITY AND PLANT FACILITIES WILL BE PER STATE AND FEDERAL REGULATIONS.

THE WATER SYSTEM SUPPLY IS TO CONSIST OF WELLS AT THE NORTHERLY END OF THE SUMMIT COUNTY HIGH SCHOOL PROPERTY. THE WELLS WILL SUPPLY POTABLE WATER AT UP TO 200gpm. THE WELLS WILL PUMP TO A WATER TREATMENT AND PUMPING BUILDING WHICH WILL CONTAIN AN AERATOR TO REMOVE RADON, A TEN THOUSAND GALLON STILL WELL, HIGH SERVICE PUMPS AND A CHLORINATOR.

THE HIGH SERVICE PUMPS WILL SUPPLY WATER TO THE DISTRIBUTION SYSTEM AND TO A 250,000 GALLON WATER TANK LOCATED AT A HIGH SPOT IN THE HIGHLAND MEADOWS PUD PROPERTY AT THE REAR OF LOT 23. THE TANK WILL PROVIDE RESERVE CAPACITY FOR FIRE FIGHTING AT 1,500 gpm FOR TWO HOURS, SEVERAL DAYS DOMESTIC SUPPLY AND NOMINAL DEAD STORAGE.

THE DISTRIBUTION SYSTEM WILL CONSIST OF 8" DUCTILE IRON PIPE SUPPLYING FIRE HYDRANTS, RESIDENCES AND RETAIL/COMMERCIAL CUSTOMERS.

THERE IS TO BE NO CONNECTION TO THE EXISTING TOWN OF BRECKENRIDGE WATER SUPPLY MAIN TO THE HIGH SCHOOL.

LATEST REVISION		
<b>WATER SUPPLY AND DISTRIBUTION PLAN</b>		
<b>HIGHLAND MEADOWS PUD</b>		
DRAWING # OCT97.DWG	By: FARMER'S KORNER, INC.	DATE 8-05-98
DRAWN BY GAP		SCALE 1" = 200'
FIELD BOOK NA	SUMMIT COUNTY, COLORADO	SHEET 15
<b>PEARSON ENGINEERING, INC.</b> P.O. BOX 1308, FRISCO, CO 80443 970 668 5067		

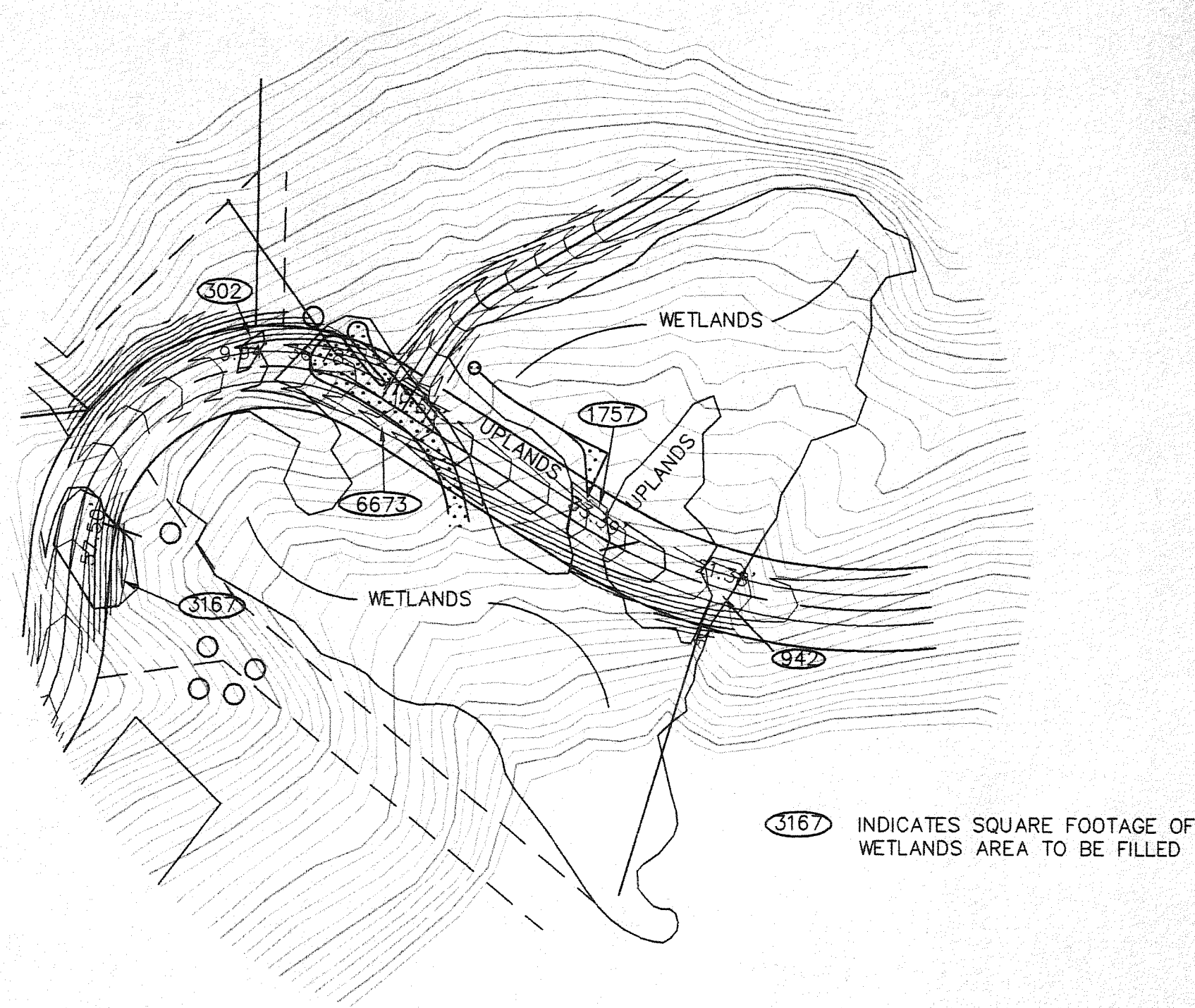

3167 INDICATES SQUARE FOOTAGE OF WETLANDS AREA TO BE FILLED

WETLANDS FILL AREA  
1" = 100'

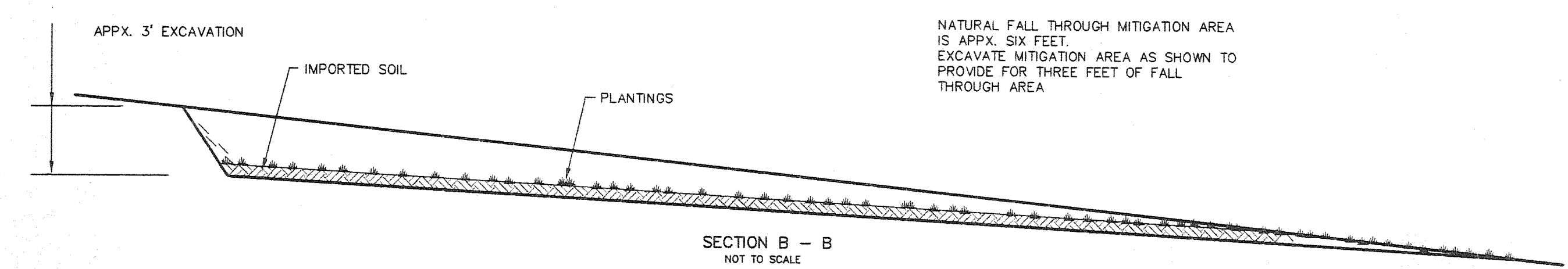

SECTION B - B  
NOT TO SCALE

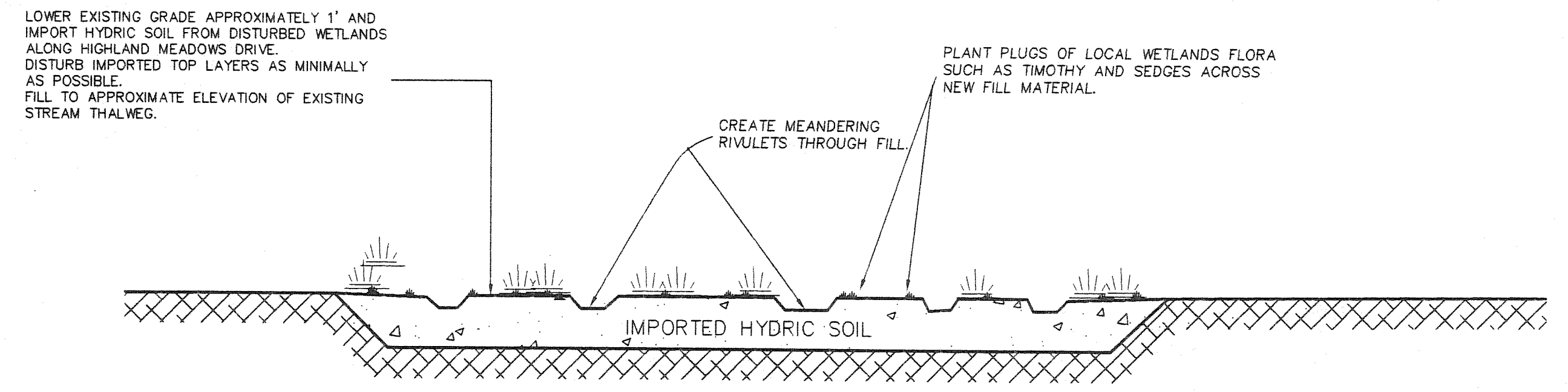

SECTION A - A  
NOT TO SCALE

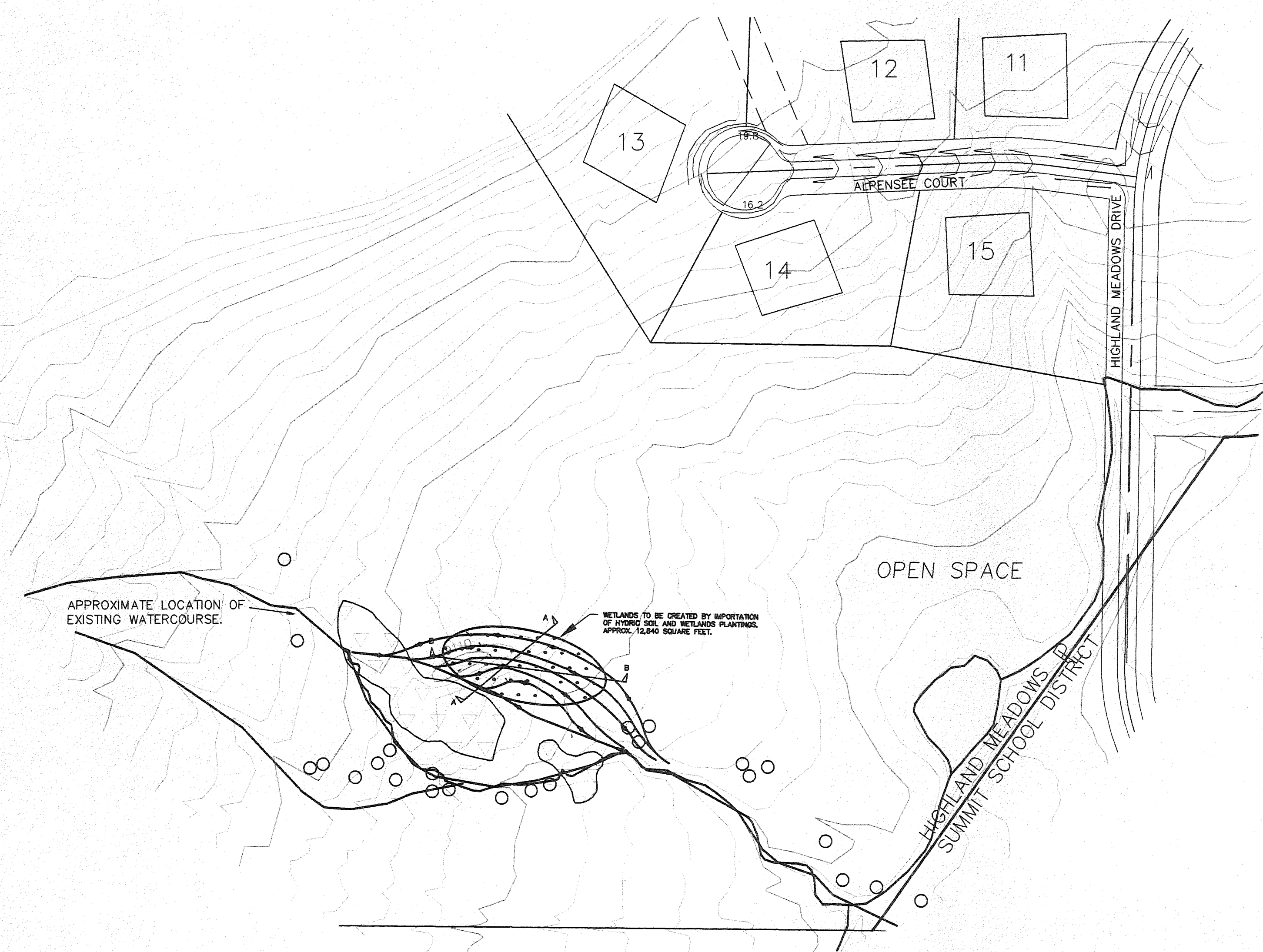

MITIGATION AREA  
1" = 100'

APPROXIMATELY 13,200 S.F. OF WETLANDS FILL IN THIS AREA IS ALLOWED UNDER NWP#26. ALL PROVISIONS OF NWP#26 ARE TO BE MET INCLUDING NOTIFICATION OF THE ARMY CORPS OF ENGINEERS AT PROJECT COMPLETION.

SUGGESTED CONSTRUCTION SEQUENCE:  
EXCAVATE MITIGATION AREA.  
CAREFULLY IMPORT HYDRIC SOIL FROM AREA OF WETLANDS TO BE DISTURBED ON HIGHLAND MEADOWS DRIVE.  
ESTABLISH DRAINAGE PATTERN THROUGH MITIGATION AREA.  
HAND PLANT WILLOW CUTTINGS IN MITIGATION AREA.

<b>WETLANDS MITIGATION PAN</b>		HIGHLAND MEADOWS PUD	
DRAWING # 950901WT	By FARMER'S KORNER, INC.	DATE 08-04-98	SCALE 1" = 100'
DRAWN BY GAP	SUMMIT COUNTY, COLORADO	SHEET 17	
<b>PEARSON ENGINEERING, INC.</b> P.O. BOX 1508, FRISCO, CO 80443 970 668 5067			

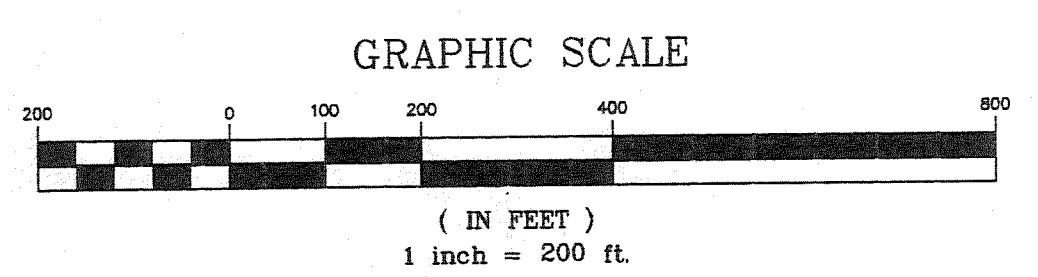
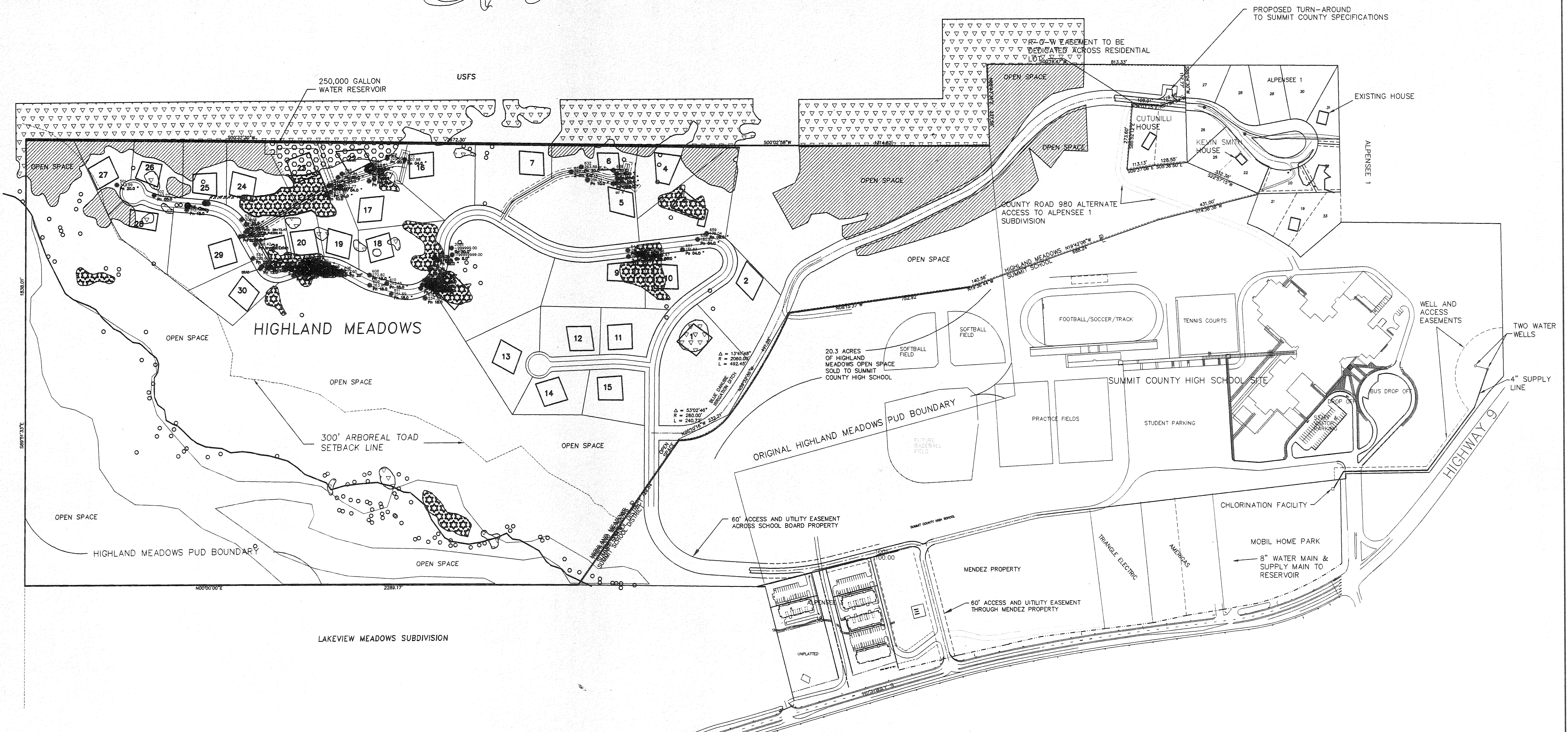
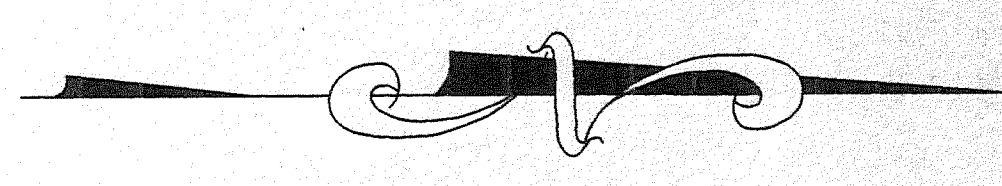

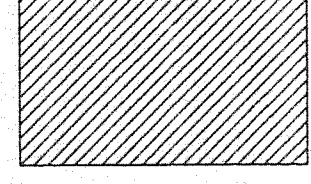
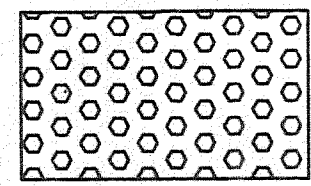
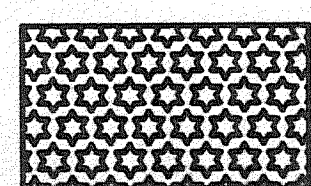
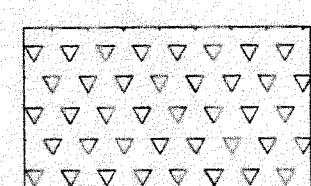
-  BLOCK 1
-  BLOCK 2
-  BLOCK 3
-  UNCLASSIFIED TREE AREAS

<b>FORESTRY PLAN</b>		
FOR FARMERS KORNER, INC.		
DRAWING # 950901FO.DWG	FARMER'S KORNER	DATE 7-8-98
DRAWN BY JAP	SUMMIT COUNTY, COLORADO	SCALE 1" = 200'
FIELD BOOK NA		SHEET 18
 <b>PEARSON ENGINEERING, INC.</b> P.O. BOX 1308, FRISCO, CO 80443 970 668 5067		